

激光打码
Laser printing

BJ42D15-26V09
LOT NO. xxxxxxxx

"XXXXXX": 生产日期
date of manufacture
例如 For example: 131207

"X": 生产线别
Production line no.
例如 For example: A, B...

励磁顺序 vs. 旋转方向
Exciting Sequence vs. Direction of rotation

STEP	A	B	C	D
1	+	+	-	-
2	-	+	+	-
3	-	-	+	+
4	+	-	-	+

CCW 从电机的安装端看，按照表格规定的励磁顺序。电机将产生顺时针方向旋转。
Exciting sequence as the table specifies will produce clockwise rotation when viewed from mounting end.

PULLEY 带轮	
TOOTH SPECIFICATION 齿型	2GT
PITCH 节距	2±0.01
NUMBER OF TEETH 齿数	20
OUT DIAMETER 外径	Ø12.22 ^{+0.05}
DIA OF PICH CIRCLE 节径	Ø12.73

电机特性 CHARACTERISTICS

项目 ITEMS	规格 SPECIFICATIONS
额定电压 Rated Voltage	DC 5.04 V
额定电流 Rated Current	DC 0.84 A / 相
步距角 Step Angle	1.8° ± 0.09°
相数 Phase	2
相电阻 Resistance per phase	6.0 ± 15% Ω / 相
相电感 Inductance per phase	8.8 ± 20% mH / 相
保持力矩 Holding Torque	≥ 280 mN.m
绝缘电阻 Insulation Resistance	≥ 100 M Ω (DC 500V)
绝缘等级 Insulation Class	B级
转子惯量 Rotor Inertia	38 g.cm ²
重量 Weight	0.22 kg REF.

接线图 Wiring Diagram:

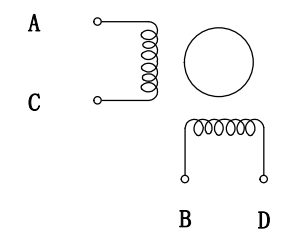

Dimensions refer to drawing		未注公差 Tolerance sheet	
单位 Unit: mm	比例 Scale: nts	0°	0 ±0.2
Product Code:		0.0°	0.0 ±0.1
Model: BJ42D15-26V09		0.00°	0.00



Model: BJ42D15-26V09

设计 Designed by

审核 Checked by

批准 Approved by

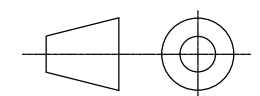

REV.	版本记录 Revision Record	日期 Date
A	原始版本 Original revision	2022.06.20

Drawing No.: Page 1 of 1 Page 版本 Version: A